



Model Number:  
**WGB-XX-197133**

RF Components

# C-Band Broadwall Coupler

3.30-4.90GHz

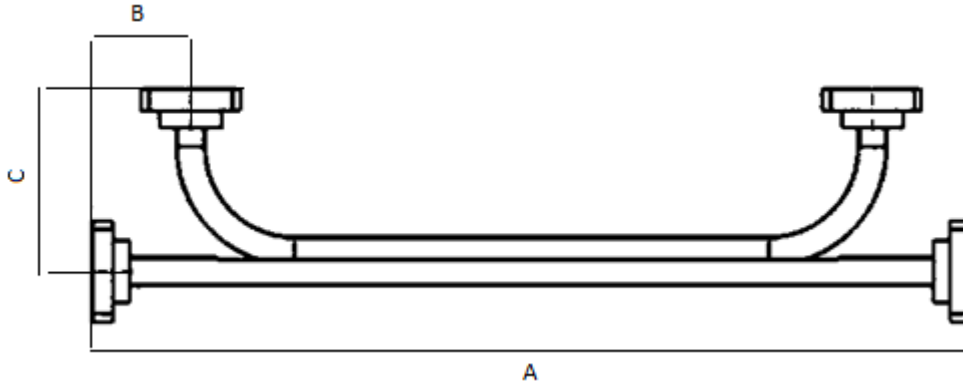

Specification				
WG Size	WG11A / WR229 / R40			
Coupling	20±2.5 dB	30±2.0 dB	35±2.0 dB	40±2.0 dB
Frequency Range	3.30 - 4.90GHz			
Finish	Brass Flanges Copper WG Black Paint			
Flange Options	CPR 229G (CG) / CPR 229F (CF) PDR 40 (PD) / UDR 40 (UD)			
Main Line VSWR / Return Loss (max)	1.05:1 / 32.3	1.05:1 / 32.3	1.05:1 / 32.3	1.05:1 / 32.3
Secondary Arm VSWR / Return Loss (max)	1.1:1	1.1:1	1.1:1	1.1:1
Directivity (min over 75% Bandwidth)	>= 25 dB	>= 25 dB	>= 25 dB	>= 25 dB
Dimensions	A-700mm B-60mm C-175mm			

Model Numbers					
Example: WGB-20-197133-UBPB					
WG	B	20	197056	UB	PB
Waveguide	C-Cross Guide D-Dual Arm B-Broad wall	Coupling Factor	Model Number	Left Hand Flanges	Right Hand Flanges

## Broadcast



## Marine Oil & Gas



## SNG & VSAT



## Satellite Teleport

